

### 4MP 25X Starlight PTZ Network Camera

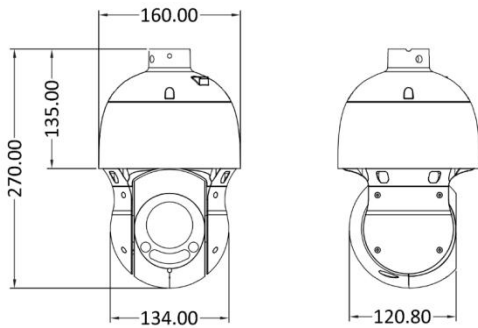

- 1/2.8" Progressive Scan 4MP CMOS
- 5.5~137.5mm, 26X Optical Zoom, 16X Digital Zoom
- Starlight Technology
- Auto tracking of all moving targets
- Smart AI (Intrusion, Tripwire, Face Detection, SMD)
- Optional: (Red and Blue Warning Lights, Built in Mic., Audio & Alarm I/O)
- IR distance up to 120M

<b>Model No.</b>	<b>CB-25X-1240</b>
<b>Camera</b>	
Digital Video Processor	1/2.8" 4MP CMOS Sensor
RAM & ROM	256M RAM / 128M ROM
Frame Rate	2592*1520
Minimum Illumination	Color: 0.001Lux@F1.5(AGC ON), B/W: 0.0005 Lux@F1.5(AGC ON)
Shutter Speed	Auto / 1/25s-1~100'000s
Slow Shutter	Support
Aperture	DC drive
Day & Night Switch	Auto, Dual IR-Cut Filter (Day / Night / Auto / Schedule)
IR Illuminator / Wavelength	Up to 120M / 850nm
<b>LENS</b>	
Lens Type	5.5~137.5mm Motorized 25X Optical Zoom Lens
Optical Zoom	25X
Digital Zoom	16X

Focus Control	Auto / Semi-Auto / Manual				
Iris Control	Auto Iris				
Aperture Value	Max. F1.5~F3.8				
<b>F.O.V.</b>					
Field of View (H)	60.6-3.2°(Wide-Tele)				
Field of View (V)	34.1-1.8°(Wide-Tele)				
Field of View (D)	69.4°~3.7° (Wide~Tele)				
Minimum Working Distance	100mm-1500mm				
Zoom Speed	Approximately 3.5s				
<b>DORI</b>					
DORI	Lens (mm)	Detect (m)	Observe (m)	Recognize (m)	Identify (m)
	5.5mm	123.8	49.5	24.8	12.4
	137.5mm	2478	992	496	248
<b>Compression Standard</b>					
Video Compression	H.265 Main Profile / H.264 High Profile / H.264 Main Profile / H.264 Baseline Profile / MJPEG				
Video Bit Rate	32Kbps~16Mbps				
Audio Compression	G.711a / G.711u / G.722.1 / G.726 / MP2L2 / AAC / PCM				
Audio Bit Rate	64Kbps(G.711) / 16Kbps(G.722.1) / 16Kbps(G.726) / 32-192Kbps(MP2L2) / 16-64Kbps(AAC)				
<b>Image</b>					
Max. Resolution	2560*1440@25/30fps				
Main Stream	50/60Hz: 30/25fps(2560*1440/1920*1080/1280*720)				
Sub Stream	50/60Hz: 25fps/30fps(704*576/640*480/352*288)				
Third Stream	50/60Hz: 25/30fps(704*576/640*480/352*288)				
Image Setting	Saturation, Brightness, Contrast, Sharpness adjustable by Client Soft. Or Browse				
Exposure Mode	Auto Exposure / Aperture Priority / Shutter Priority / Manual Exposure				
Focus Mode	Auto Focus / One Focus / Manual Focus / Semi-Auto Focus				
Area Exposure / Focus	Support				
Gain Control	Auto / Manual				
BLC / White Balance	BLC: On/Off, White Balance: (Auto / Manual / Lock)				
Defog	Support				
Day/Night Switch	Auto, Manual, Timing, Alarm Trigger				
Flip	Normal / Flip Vertical / Flip Horizontal / 180° / 90°Clockwise / 90°Anti-clockwise				
HLC	Support				
Image Stabilization (EIS)	Support				
DNR	3D DNR				
WDR	≥ 140dB				
S/N Ratio	≥ 60dB				
Picture Overlay Switch	Support BMP 24-bit image overlay, customizable area				
Region of Interest	Support 3 streams and 4 fixed areas				
Privacy Mask	On/Off, (8 Areas, Rectangle)				
<b>Network</b>					
Protocols	IPv4/IPv6, HTTP, HTTPS, FTP, SMTP, UPnP, SNMP, DNS, DDNS, NTP, RTSP, RTP, TCP/IP,				

	UDP, DHCP, PPPoE,
API	Onvif (Profile S, Profile G)
Baud Rate	1200 / 2400 / 4800 / 9600bps (Default:115200bps)
Streaming Method	Unicast / Multicast
Simultaneous	Live View Up to 9 Channels
User/Host	5 Users
Security	Password Protection, Complicated Password, HTTPS Encryption, IP Address Filter, Control Timeout Settings
Video Management Software	IE / Web / PC Client Software / App
WEB	IE10/11, Safari V12.1 above, Firefox V.52 above, Google Chrome V.57 above, Edge V.79 above
Mobile Client	iOS, Android
P2P	Support iOS / Android / PC
<b>PTZ</b>	
Horizontal Rotation Range	0~360°
Horizontal Rotation Speed	Pan Speed: Configurable from 0.1° to 200°/s; Preset Speed: 200°/s
Tilt Rotation Range	-18~90° (Auto Flip)
Tilt Rotation Speed	Tilt Speed: Configurable from 0.1° to 200°/s; Preset Speed: 200°/s
Preset Points	255
Patrol Scan	6 Patrols, up to 18 Presets per patrol
Pattern	4 Patterns, with total recording time not less than 10mins
A-B Scan	User Programmable
A-B Scan Speed	8 Levels Setting Available (Low / Medium / High)
3D Positioning	Support
PWR On Action	Memory / Pattern 1 / Tour 1 / 360° Scan / A-B Scan / Preset 1-18 / None
Park Time	5~720s available
Dwell Preset	10~120s available
Power-Off Memory	Support
Anti-Flash	50Hz / 60Hz
<b>Infrared</b>	
IR distance	Up to 120M
IR intensity	Automatically adjusted, depending on the zoom ratio
<b>Interface</b>	
Ethernet Interface	RJ45*1, 10M/100M self-adaptive
Storage	Support 256G Micro SD / SDHC / SDXC offline local storage, NAS (NFS, SMB / CIFS support)
Alarm	1CH Input, 1CH Output (Optional)
Audio	1CH Input, 1CH Output (Optional)
<b>Alarm</b>	
Snapshot	Remote Timing Snapshot, Mobile View Images Snapshot
Motion Detection	Intelligent Multiple Detection Zones (Max. 4 Zones)
Alarm Linkage	E-mail Alert and Upload Snapshot to FTP, Relay Out, Mobile Phone App
<b>Event</b>	
Basic Event	Motion Detection, Alarm Input and Output

Intelligence	
Face Detection	Supported
Smart Motion Detection	Supported
Perimeter Protection	Intrusion, Tripwire (support the classification of Human and Vehicle & Non Motor)
Smart AI Function	Area Intrusion, Cross-Border Detection, Entering/Leaving Area Detection, Hovering Detection, Parking Detection, Personnel Gathering Detection, Scene Change Detection
Smart Tracking	Auto Tracking
Alarm Linkage	Upload to FTP, E-mail, Trigger Alarm Output, Trigger Recording
General Parameter	
Operating Temp.	Indoor: 0~40°, Outdoor: -40°~+65°
Humidity	≤ 95% Non Condensing
Power	AC 24V
Power Consumption	≤ 36W
Dimension	270(W)*160(H)mm
Weight	3.5KG
Protection Level	IP66, TVS 4000V Lightning Protection, Surge Protection
Mounting Bracket	Wall Mount Bracket or Ceiling Mount Bracket
Approvals	
Certification	CE / FCC / RoHS
ISO	ISO9001